

CUBIC RANGE DESIGN SOLUTIONS

DESIGNED TO INTERNATIONAL STANDARDS

Ranges To Meet All Training Requirements

Cubic Range Design Solutions (CRDS) has a proven track record as range design consultants and contractors for specialised training facilities involving multidisciplined and often complex turnkey requirements.

Our team of range designers, architects, project managers and engineers work closely with end-users to carefully analyse their training needs to reach the final design and deliver an effective training facility.

Our designs use the most advanced specialist range equipment including ventilation, bullet protection, targetry, simulation, and safety and monitoring systems.



Indoor Range Systems

- Conventional and video simulation systems
- Acoustic and anti-ricochet materials
- Bullet traps
- Ventilation systems
- Control and monitoring systems
- Advanced targetry solutions

Outdoor Range Systems

- Conventional gallery and open ranges
- Baffled ranges
- Targetry and scoring systems
- Control and support buildings



Top right, 300m outdoor range

Top left, 100m indoor range with targetry and live-fire simulation

Above, Indoor range with overhead retractable targets

SPECIALIST FACILITIES

Delivering State of the Art Specialist Training Facilities

CRDS has the capability to design, fabricate, deliver and install bespoke facilities together with simulation and training solutions.

Training Mock-ups

We have designed and constructed full-size mock-ups of aircraft, marine vessels, oil platforms, underground and aboveground stations and train carriages. Our designs incorporate realistic door and window openings and other features to ensure that training is as realistic as possible.

Urban Ranges

From simplistic house and building facades to comprehensive training villages, our urban ranges provide invaluable training for Urban Operations, Public Order and Counter-Terrorist training.

Close Quarter Battle Houses

We design and build CQB houses for military units and Special Forces to train and practise close quarter combat drills and tactics using live ammunition. A typical "killing house" consists of several rooms on two or more storeys, linked by corridors, staircases and elevators. The interior is fitted with anti-ricochet walls, ceilings and floors, and soft bullet traps are used for bullet containment.

Specialist Facilities and Training Centres

We have designed and constructed many specialist facilities and complete training camps for training security personnel in counter-terrorist and maritime counter-terrorist techniques

Examples

- Indoor and outdoor shooting ranges
- Close Quarter Battle (CQB) houses
- Method of Entry (MOE) buildings
- Maritime Counter-Terrorist facilities
- Live-fire Urban Operations ranges and training villages
- Re-configurable partition systems (both bulletproof and non-bulletproof)
- Full-size mock-ups and part-task trainers (aircraft, ships, trains, oil rigs)
- Sniper and commando towers
- Live-fire drive-in ranges and drivertraining circuits
- Modular live-fire shooting ranges (QuickRange®)



Urban Ranges



Full-size mockup of aircraft

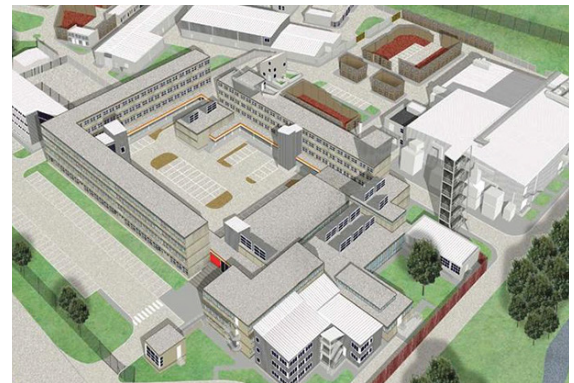

Example training center